

◆ How to Register

"TOHOKU MaaS" registration is required before using "YOBUNORU KAKUNODATE". Member registration is free. This service is only available for smartphones.

TOHOKU MaaS



Step1



Step2

Tap "New registration and login with JaM id"

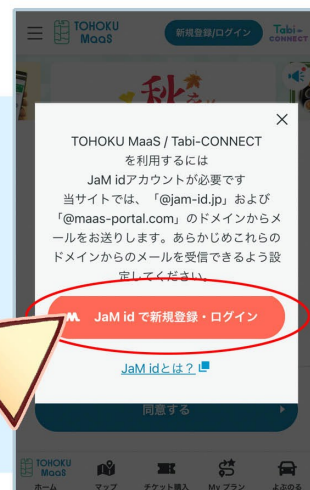

Step3

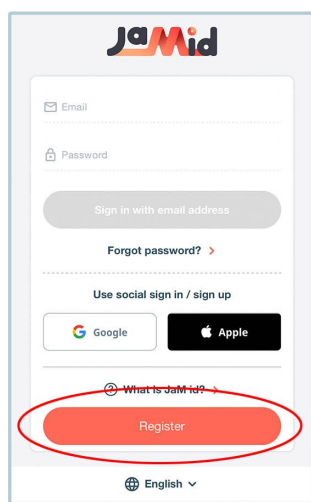

Tap "Register"

Step4

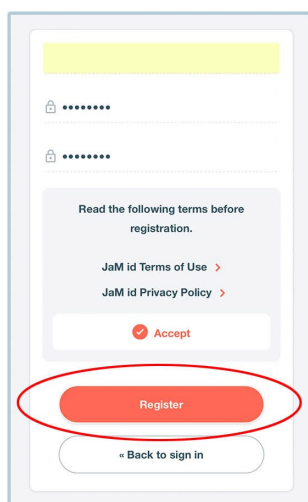

Read the Terms of Use and the Privacy Policy, and enter your email address, password, and tap "Register"

Step5

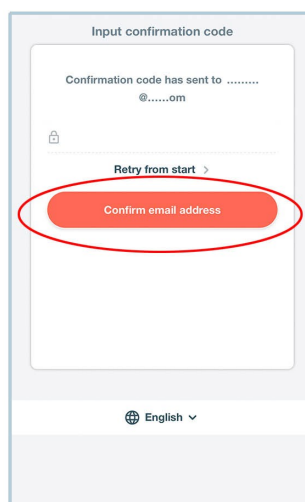

Enter the 6-digit verification code sent to your registered email address and tap "Confirm email address"

Step6

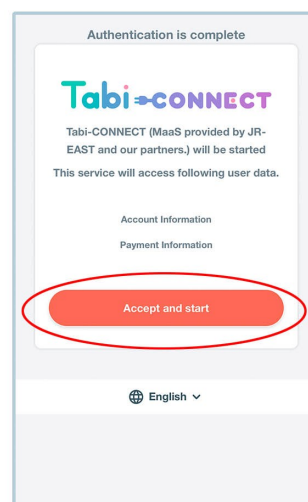

Tap "Accept and start"

Step7

Read the Terms of Use and tap "Agree to the terms and register"



Step8

Enter the necessary information and tap "Registration"

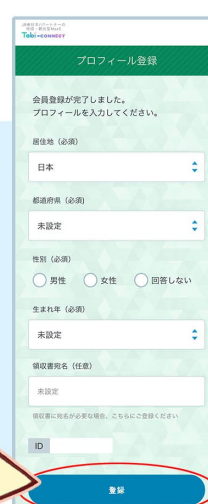

Registration Completed!



◆ How to make a Reservation

Let's explore with shared transport "YOBUNORU KAKUNODATE"! Before taking a ride, reservation from "TOHOKU MaaS" is required.



Step1



Login into "TOHOKU MaaS" with your JaM id, and tap "YOBUNORU"



Step2



Tap "New reservation"

Step3

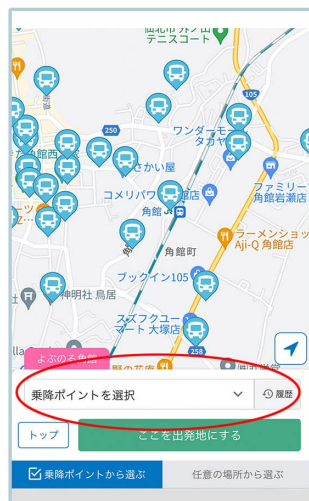

Select "Pick up location" and "Drop off location"

Step4

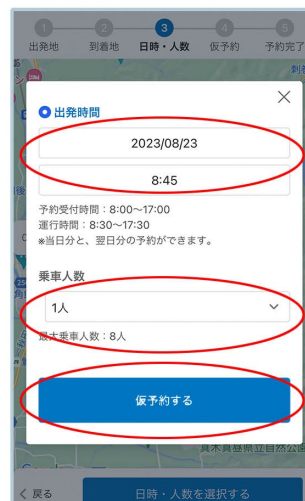

Select "Departure time" and "Number of passengers"

Step5



Check the details of your reservation and tap "Confirm the reservation"

Step6



Reservation Number is given when your reservation is complete. Take a screenshot of reservation, and show the reservation number to the driver when boarding.

Fares are paid to the driver upon boarding. After showing your reservation number, you can pay by cash or IC Cards, or show your E-tickets.



◆ How to purchase and use E-tickets

E-tickets of "YOBUNORU KAKUNODATE" are available on "TOHOKU MaaS" website.

Step1



Login into "TOHOKU MaaS" with your JaM id, and tap "YOBUNORU"



Step2



Tap "Ticket purchase"

Step3



YOBUNORU KAKUNODATE Single Ticket
1回乗車券

YOBUNORU KAKUNODATE One-Day Ticket
1日乗り放題券

Select your desired ticket

Step4



Check the price, operation information usage, etc., and tap "Proceed to ticket purchase"

Step5



Please read the pre-cautions regarding ticket purchase, select the number of tickets to purchase and tap "Proceed to confirmation"

Step6



Please select a payment method. Tap "Add credit card information" to enter information

Step7



Tap "Confirm the purchase". Confirm the membership agreement and tap "Agree and confirm purchase" to complete E-ticket purchase

Step8

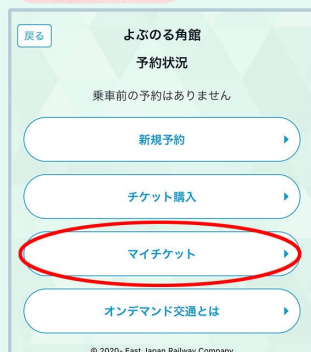

To use the purchased ticket, please tap "YOBUNORU" from "TOHOKU MaaS" as shown in Step1, and tap "My ticket"

Step9



Tap the purchased E-ticket before use. "YOBUNORU KAKUNODATE One-Day Ticket" is valid only for the day when you use the ticket

Step10

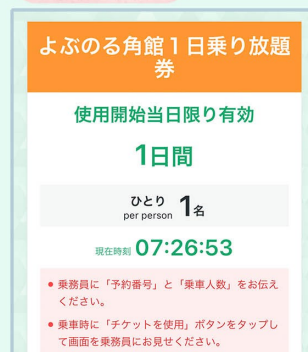

Tap "Use the ticket" and "OK" to confirm. For E-ticket of several rides like "One-Day Ticket", please repeat Step8 to 10 to show the ticket again

Step11



The ticket is valid now. Please show this screen to the driver. Make sure that the current time is automatically updating